

**MORE FROM WOOD.**



[www.egger.com/buildingproducts](http://www.egger.com/buildingproducts)

FRITZ EGGER GmbH & Co. OG  
Holzwerkstoffe  
Weiberndorf 20  
6380 St. Johann in Tirol  
Austria

EGGER Holzwerkstoffe Wismar  
GmbH & Co. KG  
Am Haffeld 1  
23970 Wismar  
Germany

EGGER Sägewerk Brilon GmbH  
Im Kissen 19  
59915 Brilon  
Germany

SC EGGER România SRL  
Str. Austriei 2  
PO Box 38  
725400 Rădăuți, jud. Suceava  
Romania

Egger Building Products

**Advanced solutions  
for consultation, planning  
and construction**



# Content

## Our products – our quality



OSB 4 TOP	6
OSB 3	8
Ergo Board	10
DHF	12
Timber	14
Market-specific solutions and boards	16
Excellent product properties	18
More from wood stands for more transparency	20

## Our products in your construction project



Our products in your construction project	22
Digital Planning with EGGER data	24
BIMobject	26
EGGER Construction Catalogue App	27
Construction and planning in timber and dry construction	28
Packaging, panelling, trade fair construction and shopfitting	30

## Other services and information



Technical support	32
Building Products Downloads	32
myEGGER	35
Social media	35



# Wood is the first choice

The construction industry is currently revolutionising. More and more buildings are being built using wood. No other building material can live up to its sustainability and energy-efficient performance and speed of which it can be built with.

In construction projects, it is important to have the right products and the right solutions at hand. The expectations of the landlords are high and in order to meet the demands, the details often count for a perfect result. With our products and services, we provide modern solutions for consulting, planning and construction to precisely meet customer requirements.

See for yourself.

# Our products – our quality

**The quality of our products is our top priority.**

Our goal is to bring products with the best characteristics to the market. That is why we not only place high demands on precision during production, but also on the raw materials used – because that is where quality begins.

During the manufacturing of our products, we use natural wood from sustainably managed forests. They are manufactured in a resource-efficient manner in strict compliance with all environmental requirements and are regularly subjected to environmental hygiene tests. In addition to our own quality checks our products are subject to ongoing external monitoring by independent, accredited institutes.

**Through all these measures, we guarantee the highest quality standard and the best level of product and application safety.**



The timber construction board – this board does not comply with the standard. It exceeds it.

# EGGER OSB 4 TOP

The EGGER OSB 4 TOP with excellent timber construction properties meets all the necessary requirements during installation. The high load-bearing capacity and stiffness as well as moisture resistance and dimensional stability offer safety in all construction applications. It is also low in emissions as it is glued without formaldehyde.

Our EGGER OSB 4 TOP is available with **straight edging** as well as with **tongue and groove profile**.



## Key advantages of the EGGER OSB 4 TOP:

### In the wall:

→ **3 in 1 function:** In a single operation, the OSB 4 TOP achieves air tightness, integrates a vapour barrier, and provides the reinforcement of the construction.

→ **Floor-to-ceiling formats:** The floor-to-ceiling formats with lengths of up to 3,30 m ensure maximum flexibility in construction. During installation, there are no horizontal board joints, which do not have to be elaborately glued and backed airtight.

### In the roof:

→ **Moisture resistance:** OSB 4 TOP offers a high degree of moisture protection when used as load-bearing formwork or substructure for metal roofing or flat roof waterproofing.

→ **Dimensional stability:** The high dimensional stability of the board ensures stable dimensions in a changing ambient climate.

### In the ceiling:

→ **High load-bearing capacity:** The high load-bearing capacity of the OSB 4 TOP makes it ideal for planking wooden beam ceilings.

→ **Maximum format:** Thanks to the maximum format of 11,50 x 2,80 m it is possible to prefabricate large components with little effort.

→ **Bending strength:** Due to the high stiffness of OSB 4 TOP, the same performance compared to OSB 3 can be achieved with reduced board thickness.

### As dry screed:

→ **Squareness:** Due to the precise squareness of the boards, they can be installed directly and quickly.

### Precisely fitting tongue and groove profile:

Due to the precise shaping of the tongue and groove profile, the boards naturally fit into each other. The result is a tight fitting combination.

» Technical material properties, our delivery programme and further important information on the product can be found at [www.egger.com/osb4top](http://www.egger.com/osb4top)

## MORE TRANSPARENCY:



– 753 kg CO<sub>2</sub>/m<sup>3</sup>



93 % material from renewable resources



96 % virgin material\*  
\* mainly industrial roundwood



55 % regional wood sources



100 % verified legal wood origin  
46 % of that certified

The calculations of the values refer to the location Wismar (DE).



Renovation, packaging, panelling.  
Everything is possible with our all-rounder.

# EGGER OSB 3

EGGER OSB 3 is our multipurpose board for a wide range of applications. As type OSB/3 according to EN 300, it offers good mechanical strength, stiffness and durability even under temporarily humid ambient conditions. Its areas of application range from various applications in timber and trade fair construction, in prefabrication, as packaging material through to use in formwork construction.

Our EGGER OSB 3 is available with **straight edging** as well as with **tongue and groove profile**.

## Key advantages of the EGGER OSB 3:

### In timber and trade fair construction:

- **High dimensional stability:** The precise production and low dimensional tolerances enable rapid planking of large areas without the need for reworking.
- **Optimised tongue and groove profile:** The optimised tongue and groove profile convinces with its high robustness and accuracy and the associated easy fabrication when joining the boards.

- **Wide range of availability:** We offer a wide range of formats and thicknesses from stock.

### In prefabrication:

- **Fitting accuracy:** Due to the squareness and straightness of the edges of OSB 3, surfaces can be planked without reworking.
- **Reliable raw density:** The OSB 3 has an assured raw density of at least 600 kg / m³. In addition to the machine processability (vacuum lifting) this has a positive effect on the edge stability, the air tightness as well as the vapour-barrier function.

### As packaging material:

- **Food safety:** The OSB 3 can also be used as transport packaging for food or feed. The fact that no additional protective packaging is necessary for this is confirmed by means of an ISEGA declaration of harmlessness.

- **Free from pests according to ISPM 15:** The OSB 3 is free from pests due to the temperatures reached in the manufacturing process.

### In formwork construction:

- **Smooth and closed surface:** Due to these characteristics of the surface, the OSB 3 offers increased moisture resistance.
- **Better swelling behaviour:** The low thickness swelling ensures delayed and slow moisture absorption of the board.

» **Technical material properties, our delivery programme and further important information on the product can be found at [www.egger.com/osb3](http://www.egger.com/osb3)**

## MORE TRANSPARENCY:



– 753 kg CO<sub>2</sub> / m³



95 % material from renewable resources



98 % virgin material\*  
\* mainly industrial roundwood



39 % regional wood sources



100 % verified legal wood origin  
34 % of that certified

The calculations of the average values refer to the locations Wismar (DE) and Rădăuți (RO).

This board lets you  
take it easy.

# EGGER Ergo Board

The EGGER Ergo Board is a lightweight wooden board especially developed for drywall construction. The special edge profiling with a shiplap joint on the long edges and a tongue and groove profile on the short edges makes it particularly quick and easy to work with.



## Key advantages of the EGGER Ergo Board:

### In the partition wall or in the attic conversion:

- **Stable grip at all points:** The EGGER Ergo Board increases wall stability and enables console loads independently of the stud frame without special dowels.
- **Increased impact resistance:** The EGGER Ergo Board increases the safety and impact resistance of partition walls in private and public buildings.
- **Verified fire resistance duration:** The Ergo Board is the only OSB that can be used for metal stud framing and still achieve a fire resistance duration of up to 90 minutes.
- **Material savings:** Simple fastening with the special shiplap joint profile reduces the effort and use of materials.

- **Easy and effortless:** As a true one-person board, the Ergo Board offers easy handling for faster assembly due to its low weight
- **Waste-optimised continuous installation:** The Ergo Board is mounted using the innovative edge profiling in continuous installation. The horizontal installation also ensures a reduction in fasteners and waste.
- **Faster mount:** The printed nail grid facilitates assembly and saves time.
- **Efficient planking:** Mineral materials can be fixed free of grid dimensions and minimise their waste.

» **Technical material properties, our delivery programme and further important information on the product can be found at [www.egger.com/ergoboard](http://www.egger.com/ergoboard)**

## MORE TRANSPARENCY:



– 753 kg CO<sub>2</sub>/m<sup>3</sup>



95% material from renewable  
ressources



96 % virgin material\*  
\* mainly industrial roundwood



55% regional wood  
sources



100 % verified legal wood origin  
46 % of that certified

The calculations of the values refer to the location Wismar (DE).

We have something against time pressure and weather changes. Now you do too.

# EGGER DHF

Our DHF sheathing panel with a tongue and groove profile is a synthetic resin-bonded, medium-density wood fibre board. As a moisture-resistant, vapour-permeable and stiffening board, it is ideally suited for the outer planking of roofs and timber frame walls. The DHF panel comes with an installation-friendly nailing grid, which ensures quick installation.

Due to the formaldehyde-free gluing and the use of natural wood, in the form of sawmill by-products, the board is particularly environmentally friendly.



## Key advantages of the EGGER DHF:

### In the roof:

→ **Rain resistance:** The DHF panel guarantees tested rain resistance and can be used as underlay or sub-roof from a roof pitch of 14° without any further measures.

→ **Hail safety:** The DHF panel is hail-proof and provides reliable moisture protection in the event of damage to the roof covering. This protection is also guaranteed during the construction phase.

→ **Can be processed without nail sealing tape:** No nail sealing tapes are required during the processing of the DHF sheathing panel.

→ **Temporary sheathing:** The DHF panel serves as temporary sheathing during the construction phase.

→ **Sustainability:** Additional vapour permeable layers (foils) can be avoided when using our DHF panels.

### In the wall:

→ **Windproof tongue and groove profile:** The optimised tongue and groove profile ensures a precise and quick installation and creates a windproof construction.

→ **Outdoor weathering:** When used in the wall, the DHF panel can be exposed to the weather for two months all year round.

→ **Floor-to-ceiling formats:** Due to their length, our DHF panel can be used to create timber frame walls for different floor-to-ceiling heights without horizontal joints.

→ **Raw density:** Thanks to the raw density of 600 kg/m³, the DHF panel can be used in standardised fire protection structures.

» **Technical material properties, our delivery programme and further important information on the product can be found at [www.egger.com/dhf](http://www.egger.com/dhf)**

## MORE TRANSPARENCY:



–584 kg CO<sub>2</sub>/m³



94% material from renewable resources



86% by-products from the sawmill industry



97% regional wood sources\*  
\* Sawmill by-products



100% verified legal wood origin  
52% of that certified

The calculations of the values refer to the location Wismar (DE).



Sawing, drying, grading:  
We give trees a career.

# EGGER Timber

EGGER Timber is available in an extensive, tested and certified product range. It is graded visually and by machine, which ensures the visual requirements as well as the mechanical strengths.

The application areas include structural products for wood construction, the prefabricated homes industry, and timber wholesale trade, as well as semi-finished products for the processing industry and packaging materials.

Our product range consists of roof battens, squared timber, solid structural timber, boards and planks as well as raw boards.

## Key advantages of EGGER Timber:

- **High quality:** Constant and continuous quality controls ensure reliable and consistent quality.
  - **High dimensional stability:** We attach great importance to high dimensional stability in our timber.
  - **Stress grading:** In addition to visual, normative criteria, the latest X-ray technology can also be used to sort according to defined standardised strength values.
  - **Completely natural:** Wood is a natural product and so our timber is also purely natural.
  - **Securely packaged:** Product packaging ensures that the goods are secured after production, both during storage and transport.
- » **Technical material properties, our delivery programme and further important information on the product can be found at [www.egger.com/timber](http://www.egger.com/timber)**

## MORE TRANSPARENCY:



– 696 kg CO<sub>2</sub>/m<sup>3</sup>



82 % regional wood sources



100 % virgin material



100 % verified legal wood origin  
77 % of that certified

The calculations of the values refer to the location Brilon (DE).

# Market-specific solutions and boards

Do you need special products for specific applications? In addition to our wide range of products available on the market, we are also happy to offer you solutions from other markets. Above a certain product-related minimum quantity, customer-specific production in our plants is possible.



## OSB with termite protection

We bring a lot of experience from our overseas markets. One of them is the termite protection. That is why, for example, our OS'Brace H2 and OS'Floor H2 fulfil the corresponding H2 classifications for Australia and New Zealand.



## Large-size OSB

Think big! Our large-size OSB are the perfect solution for prefabricated components. On request we can provide OSB up to 11,50 m in length and 2,80m in width.

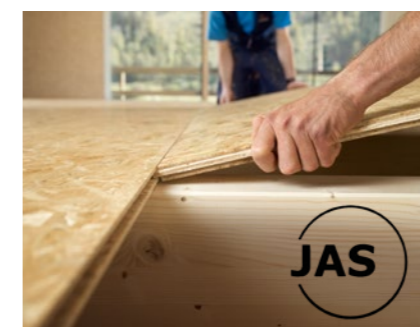

## OSB 3 JAS TOP

This panel fulfills the high mechanical requirements of the Japanese standard. Due to the formaldehyde free bonding it fulfills the strict F\*\*\* standards in Japan.



# Excellent product properties

Practical, efficient and reliable. Thanks to first-class properties, our products are not only quick and easy to process, they also form the basis for high-quality and sustainable constructions. Whatever you are planning, with EGGER building products you will succeed in your project in a simple, efficient and reliable way.

## Confirmed by the CE declaration of performance

To ensure the free movement of goods, all our building products are declared with a CE declaration of performance. This includes, among others, the following information:

- Requirements for a building product
- List of the essential characteristics of the product for the declared intended use
- System for checking and evaluating the performance durability of the product
- Details of the manufacturer

To confirm the characteristics of our products as stated in the CE declaration of performance, external monitoring is carried out twice a year. This is done by an independent, accredited institute. In this way, we assume responsibility for the conformity of our products and offer our customers certainty of proof when using them.



» All CE declarations of performance for our building products can be found here  
[www.egger.com/building-downloads](http://www.egger.com/building-downloads)



# More from wood stands for more transparency

The topic of sustainability plays a central role everywhere today. Anyone who builds with wood makes an important contribution to environmental protection. Among other things, wood grows back in just a few decades, serves as a carbon storage and ensures a healthy indoor climate when used in buildings. We have summarised all environmentally relevant information on our products in various documents.



## Eco-labels

Save time and effort on publicly tendered or sustainably certified projects when it comes to submitting the right documents. Information on environmental and health elements are already available to you, thanks to "fully declared" EGGER products.

Our **EPDs** (Environmental Product Declarations) contain information on the ingredients of our products, the use of resources, manufacturing processes and information on proper disposal. You will also find descriptions of the application of our products, proof and test reports of the product properties as well as a life cycle assessment (LCA).



In addition, our **EHDs** (Environmental and Health Datasheets) contain externally verified product information to meet the requirements of the leading certification systems **DGNB, BNB, LEED, BREEAM** for sustainable building.

» Further information on the topic of environment and sustainability as well as our EPDs and EHDs can be found at [www.egger.com/environment](http://www.egger.com/environment)

## Sustainability indicators

For us, wood is a working material and a recyclable material: We manufacture a wide range of products from nature's renewable raw material. True to our mission "**More from wood**", it is important for us to act sustainably, conserve resources and promote climate protection. Our sustainability

indicators show what our products actually contribute to achieving this promise. They make the environmental performance of each individual product transparent and easy to understand.

» You can find a detailed description of our sustainability indicators at [www.egger.com/ecofacts](http://www.egger.com/ecofacts)

### OUR SUSTAINABILITY INDICATORS INFORM YOU ABOUT:



CO<sub>2</sub> footprint



Contribution to the  
bioeconomy



Contribution to the  
circular economy



Wood proportion from the  
regional environment



Wood proportion from verified  
and certified sources



# Our products in your construction project

**You have the project – we have the product.**

While the OSB 4 TOP is the ideal material for all structural applications in new construction, renovation and refurbishment, the OSB 3 shows its strengths not only in wood and interior construction, but also in trade fair construction or shopfitting and as a packaging material. In addition, the DHF is ideal for the outer planking of roofs and timber frame walls.

We offer a range of useful services to support you in the selection and installation of our products. These include helpful tools for digital planning, the execution of timber construction or advising your builders.



For your BIM-  
or CAD-Planning.

# Digital Planning with EGGER data

The step from the analogue to the digital age is particularly important for us as a manufacturer. That is why we offer architects and planners the certified components of the EGGER construction catalogue for download in various digital data formats.

Dozens of tested constructions for walls, roofs, wooden beam ceilings and dry screed systems are available after registration in the myEGGER customer portal and can conveniently be integrated into the planning process.

» You can find the digital data for planning at  
[www.egger.com/digitalplanning](http://www.egger.com/digitalplanning)

## Your advantages:

- Simple filter search for properties such as fire, heat and sound insulation
- Designs in IFC and REVIT format for BIM planning and in DWG and DXF format for CAD planning
- Design structure including data overview as PDF file
- Planning reliability by means of tested designs
- Download of fire protection certificates and test reports
- Possibility to save favourites including update service

## Use our digital data for the following components:



Outside walls



Partition walls



Roofs



Ceilings

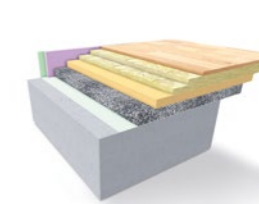

Dry screed systems

# Our digital data are also available on BIMobject

Worldwide and around the clock, our designs can be downloaded there and integrated into your planning system. BIMobject is an established provider of BIM content and PIM data sets. It is even the world's leading platform with the most visitors, registered users, BIM objects as well as downloads.



» Our data on BIMobject at  
[www.bimobject.com/egger](http://www.bimobject.com/egger)

## Your advantages:

- Planning reliability by means of collision control and early error analysis
- Cost savings through efficient and optimised planning
- Time savings due to coordinated construction processes and more precise planning
- Management of a building over the entire life cycle
- Increased competitiveness through the use of a future-proof planning method



# EGGER Construction Catalogue App

Wall, ceiling, and roof structures made with EGGER building products can be viewed in 3D detail in the Construction Catalogue. Complex construction details are visualised from all sides for a complete perspective of individual compositions in your project.

Visit **Google Play**, **Apple App** or **Microsoft Store** and install the app.



## Your advantages:

- Current material information and references to standards
- Information on fire, sound, heat and moisture protection
- Additional 2D drawings included with the construction details
- Product links for additional information available on the EGGER website
- Save most frequently used structures conveniently via the favourites function
- References via direct camera access and easy upload function for pictures and videos

» You can find a desktop version for all common browsers at  
[www.egger.com/constructioncatalogue-app](http://www.egger.com/constructioncatalogue-app)



# Planning and design for timber construction

Our building products are used in high end timber constructions, as well as in timber frame roof, wall and ceiling structures. Our materials are commonly used also in dry wall and dry screed flooring systems.

**Make use of our knowledge to facilitate your planning and construction.**



## How to use EGGER products in your timber constructions.

Visit our website to find valuable information and helpful technical leaflets for the below mentioned categories. All these documents support you during planning, structural design and construction

of your project. They serve as perfect support for the planning of structures in timber and timber frame construction as well as for the installation and fabrication of our products.

### Engineering designs for timber construction

### Planning for timber construction



#### Walls in timber construction

Information on load-bearing interior walls, partition walls or vapour-permeable exterior walls.



#### Timber frame construction

General information on the topic of timber frame construction.



#### Wooden beam ceilings

Correctly executed load-bearing subfloors of wooden beam ceilings with EGGER OSB tongue and groove.



#### Statics and structural design

Correct planning and execution of load-bearing and stiffening wall, roof and ceiling ceiling panelling.

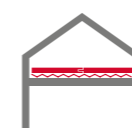

#### Dry screed systems

Create dry screeds quickly and easily with EGGER OSB tongue and groove.



#### Fire protection

Fire protection of timber constructions, fire behaviour of our boards, component classifications and test certificates.



#### Finishing and dry construction

Solutions for sound and fire protection of drywalls.



#### Wood, moisture and heat protection

Recommendations for proper moisture and heat protection as well as wood preservation.



#### Roof Structures

Optimally plan and build your wooden roof with EGGER OSB and DHF.



#### Sound insulation

Sound insulation as an essential quality factor for residents and users.



» All information and downloads on structures and planning for timber construction and finishing can be found at [www.egger.com/timberconstructions](http://www.egger.com/timberconstructions)



# Packaging, panelling, trade fair construction and shopfitting

Our OSB have many special features – one of which is their versatility. The EGGER OSB are not only ideal for timber construction, but also for formwork, booths at trade fairs, shopfitting and as packaging material.

## One board, many applications

The variety of applications is achieved by the simple and quick processing, with no need for special tools as well as the high static load capacity. Find out how to use EGGER OSB in the below application on our website.

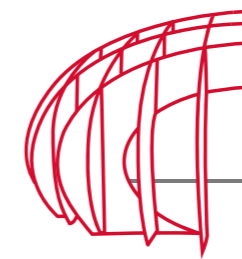

### Trade fair construction and shopfitting

In trade fair construction and shopfitting, the EGGER OSB is mainly used for load-bearing coverings in stage and warehouse construction. It also serves as a decorative element with coloured surface design.

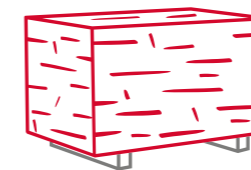

### Packing and transport

Whether as reusable transport boxes, disposable packaging for domestic or overseas transport. Thanks to numerous certificates and verifications, we offer an ideally suited packaging material.

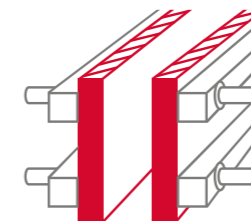

### Formwork with OSB

EGGER OSB is used for a wide variety of purposes in classic shell construction (solid construction). In formwork construction, it can also be used to produce exposed concrete with a characteristic surface texture

» Further information and technical leaflets with helpful details on the application can be found at [www.egger.com/further-applications](http://www.egger.com/further-applications)

# Further services and information

It is important to us that you achieve the greatest benefit from our products. That is why EGGER offers a whole range of services to support your projects.

## Technical support

More service, more knowledge – our technical support answers questions on building physics, fire protection and static design in timber constructions. The focus of the consultation is on economical and practical structures as well as the professional application of our building products.

[buildingproducts@egger.com](mailto:buildingproducts@egger.com)

## Building products downloads

You can find all the documents mentioned in this brochure and many more product and application-related documents at a glance in our building products download area.

[www.egger.com/building-downloads](http://www.egger.com/building-downloads)

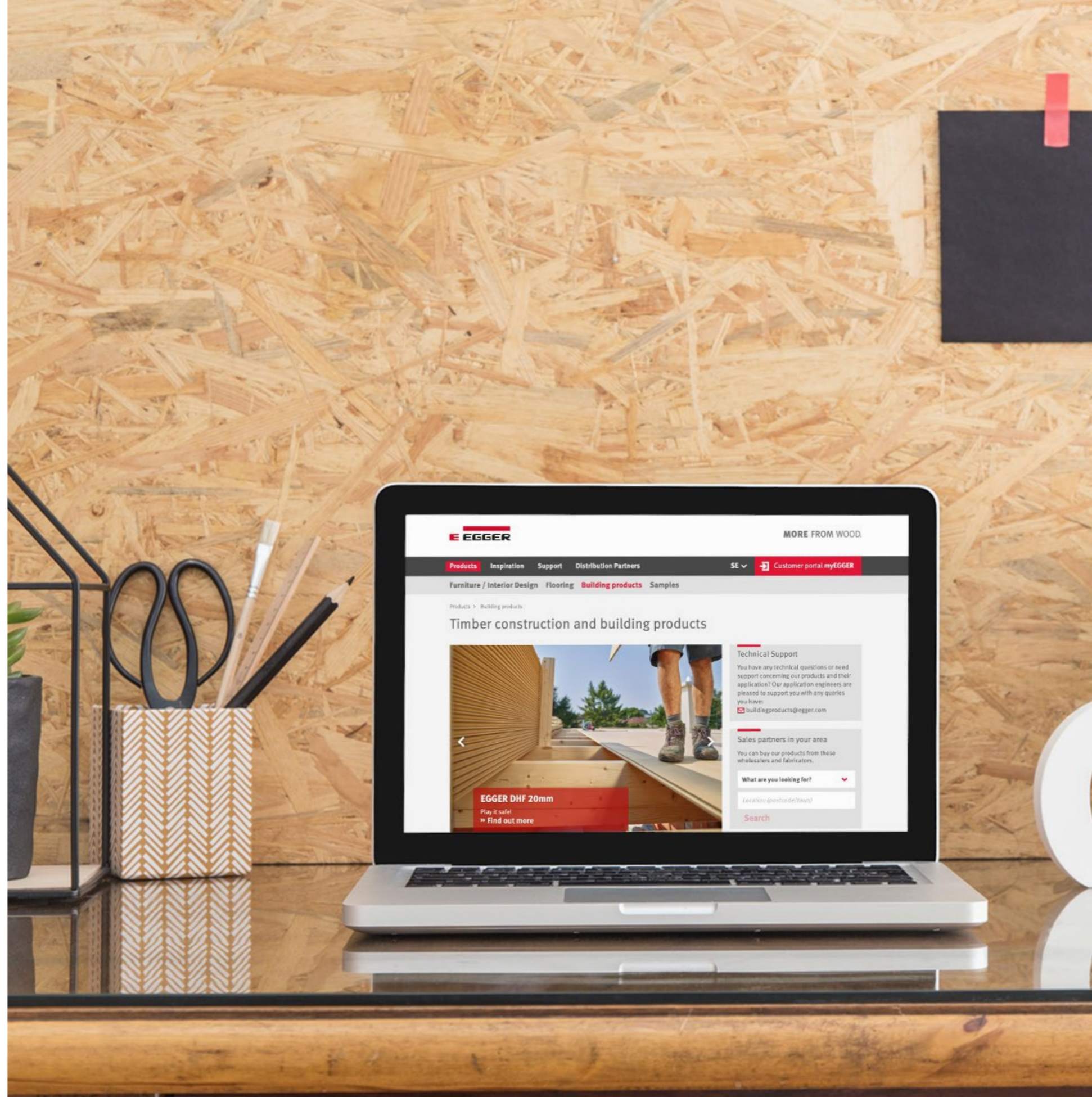



## myEGGER

Register in our **myEGGER customer portal** and enjoy exclusive content and advantages:

- ➔ Use of our digital data for construction planning in BIM and CAD systems
- ➔ Download current product data for e-commerce and PIM in real time
- ➔ Download product and application images for your own marketing activities
- ➔ Registration for the Building Products Newsletter – stay up to date
- ➔ Direct sample order via our shop  
[www.egger.com/myegger](http://www.egger.com/myegger)

## Social Media

Follow us on Facebook, Instagram, LinkedIn or YouTube and get the latest information about our company and our products.

