

Installation recommendation for EGGER Structural Flooring

Span-rated floor OSB 3 E0 T&G4

EGGER Structural Flooring – Made by experience



General information and application

EGGER Structural Flooring 4-sides tongue and groove panels provide reliable load-bearing capacity, excellent flatness, accuracy and fast progress on installation. The 100% formaldehyde free bonding resists humid conditions complying with service class 2 acc. to EN 1995-1-1.

The OSB T&G 4 boards can be used in supported floors laid on timber joist or I-beams with an accurate centre-centre spacing of 600 mm in dry. Another application area is the continuously laying in floating floors and dry screed.

Storage and Handling

EGGER Structural Flooring 4-sides tongue and groove panels are foreseen in applications and uses not permanently exposed to the weather elements. Please follow the basic rules – for more information see the referenced guideline.

- Ship and store panels under tarp
- Set bundles on supports to keep approx. 10 cm off the ground
- When storing outdoors, cover panels loosely with waterproof protective material, assure good air circulation
- When high moisture exists, cut strapping of the stack to prevent edge damage.
- Handle carefully to avoid dropping panels on corners or edges and damages of tongue and groove.
- Handle the units with care when moving them with heavy equipment

Product Service Conditions

Delivered with a moisture content of 5 - 6 % the equilibrium moisture content (EMC) in use is not allowed to exceed 18%. For further information see also CEN/TR 12872, table 1 "EMC related to the surrounding climate conditions" and table 2 "Dimensional change due to change of moisture content". It is recommended that adequate ventilation be provided. Panels shall be acclimated to service moisture conditions before installation. Supports must be dry and free of ice

Edge design

The shape of the EGGER OSB tongue and groove profile is conical and asymmetrical, to facilitate installation in difficult spots (i.e.: floor-to-wall connection). The design of the profiles allows an expansion gap of 1 mm to be generated automatically inside the groove and another one on the rear side of panels jointing, when connecting the boards (figure 1). The panels jointing on the top side is smooth and barely visible.

Figure 1:

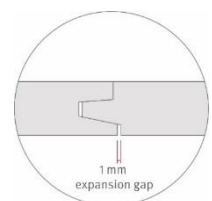
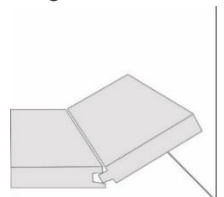

Figure 2:



Installation

Supported Panel Installation

- Install panels over two or more spans with the long dimension (major axis) perpendicular to the floor framing.
- **All 675 mm panel edges must be installed supported on joists even when interlocking in tongue and groove.**
- All free ends towards adjacent walls or openings must be supported.
- Install the panels with the CE marking stamp facing down.

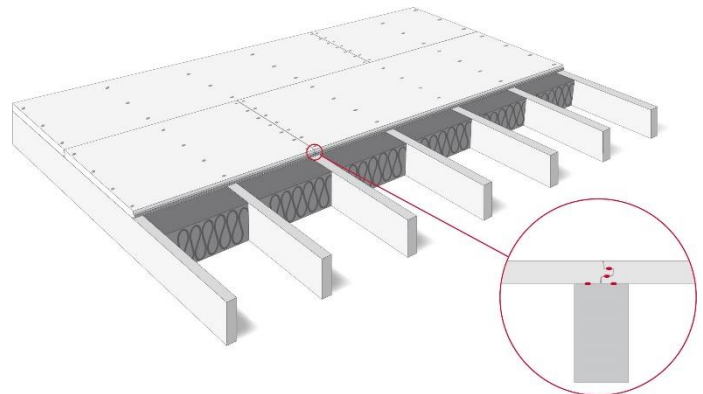

Figure 3:

Panel Spacing

- Tongue & groove panels are designed to self-space on T&G edges bottom side.
- End joints of adjacent panel runs should be staggered minimum one c-c space.
- Provide a 10 mm expansion gap to adjacent walls and studs. Cut-outs for plumbing and electrical components should be oversized by at least 10 mm to avoid a forced fit.
- In large floor areas at each 10 m length of a room dimension a 10 mm expansion gap shall be provide.

Fastening

Glue and galvanized nails or screws shall be used to insure greater floor stiffness and avoid creaking. Gluing helps eliminate nail-popping and floor squeaks. Screws provide the best and durable fastening result. The use of ring shank nails or screw shank nails is permitted, staples approved, but not recommended.

- Tongue and groove must be fully glued at time of installation.
- Use only glue of strength class D3 or D4 which conforms to industry standards, and follow manufacturer's recommendations.
- Before each panel is placed, a double line of glue should be applied to the joist. Glue should be squeezed out visible when boards are fastened and removed after curing.
- Fasteners should penetrate framing members at least 25 mm. It is recommended that fasteners have a length of 2,5 times panel thickness
- Apply fasteners minimum 12 mm from panel edges.
- Space fasteners 150 mm on supported edges and 300 mm at intermediate support locations. Insure that all corners are securely fastened.

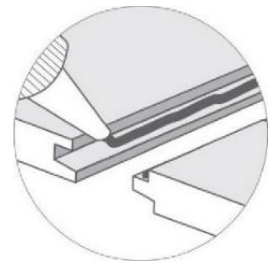

Figure 4:

Floor Coverings

- To improve sound insulation of the floor it is recommended to install a dry screed of sound insulation layer and floating floor.
- *Carpet and pad:*
May be installed directly over EGGER OSB flooring panels. Prior sanding may be required.
- *Vinyl:*
A minimum 6 mm underlayment or filler is very recommended. Follow manufacturers instructions.
- *Hardwood floors, parquet, laminate floor:*
May be applied directly over 22mm EGGER OSB flooring panels.
For installation follow the recommendations of the manufacturer.

Packaging information

Nominal Length x Width	Thick- ness	Net face width	Area per panel [net coverage area]	Pcs.per package	Area per package
2400 x 675 mm	22 mm	675 mm	1,62 m ²	44	71,2 m ²

Additional documents

Further information is provided in the following Technical Leaflets:

- Declarations of Performance EGGER OSB (DOP-734)
- Storage Instructions for EGGER OSB and EGGER DHF (TLBP002),
- Transport and Handling Instructions for EGGER OSB and EGGER DHF (TLBP001)
- Static Design Guideline for EGGER OSB and EGGER DHF (TLBP103)

EGGER Holzwerkstoffe Wismar GmbH & Co. KG · Am Haffeld 1 · 23970 Wismar · Germany · www.egger.com
 T +49 800 344 37 45 EGGER Service-Center

Provisional note:

This packaging guideline has been carefully drawn up to the best of our knowledge. The information provided is based on practical experience, in-house testing and reflects our current level of knowledge. It is intended for information only and does not constitute a guarantee in terms of product properties or its suitability for specific applications. We accept no liability for any mistakes, errors in standards, or printing errors. In addition, technical modifications may result from the continuous further development of EGGER OSB and EGGER DHF product range, as well as from changes to standards and public law documents. The contents of this guideline should therefore not be considered as instructions for use or as legally binding. Our General Terms and Conditions apply.

