

## Technical data sheet

### EGGER Decor Mix & Fill



### Application area

- Repair kit for repairing mechanical damages on laminate floors. Prevents that moisture and dirt can enter into damaged flooring.
- Deliverable in sets. 1 set for light shades, 1 set for dark shades and 1 set for greyish shades.  
A set contains 1 tube paste + 2 bottles of pigments. The paste is mixed with the 2 pigments in order to get the aimed colour.

### Standard data

Product	
Material	Repair paste
Colour	White
Delivery form	Blister
Packaging	Tube 50 g
Approvals/ Certificates/ Declarations	See Safety Data Sheet
Material	Pigment 1 & 2
Colour	Brown, black, gray
Delivery form	Blister
Packaging	2 bottles á 5 ml
Approvals/ Certificates/ Declarations	See safety data sheet

### Material data

Parameters	Specification	
Dimension	mm	215 x 105 x 45
Weight	kg	0,15
Storage		Can be stored in sealed original containers for at least 12 months Store frost-free and cool between + 5 and + 25 °C Keep out of reach of children
Transport classification		Not dangerous goods

## Logistic parameters

Description	Parameter	Value
Specifications blister	Quantity	1
	Paste g/ Pigment ml	50/ 10
	Dimensions [mm]	215 x 105 x 45
	Weight [kg] +/- 5 %	0,15
Specifications pallet	Quantity	500
	Paste kg/ pigment l	25/ 5
	Dimensions [mm]	1200 x 800 x 1250
	Weight [kg] +/- 5 %	100

## Application

- First clean the damaged floor, removing any dust, oil, wax or grease.
- Then cover with tape the damaged place on the floor (fig. 1).
- On the back of the inlay, you can choose from a multiplicity of colour mixture.
- Choose the colour which best matches the damaged decor. The correct mixing relation is shown next to the colour.
- Apply the recommended quantity of the paste on the back of dosing packing or non-absorbent underground. Shake pigment bottles well before use. Then add the prescribed number of drops of pigment to the paste and mix until smooth (fig. 2).
- Mixed colours may deviate from the colours shown on the back. The mixing proportions can be adjusted as desired. Use the mixed paste within a few minutes.
- Fill the damage place with the enclosed spatula (fig. 3) and remove the tape.
- With a damp cloth wipe immediately the surrounding laminate and allow the paste to dry.
- In the case of deeper damage, the paste may be applied in several layers.
- Allow the paste to dry for at least 1 hour before treading on the floor.
- You need a minimum handling temperature + 5 °C.

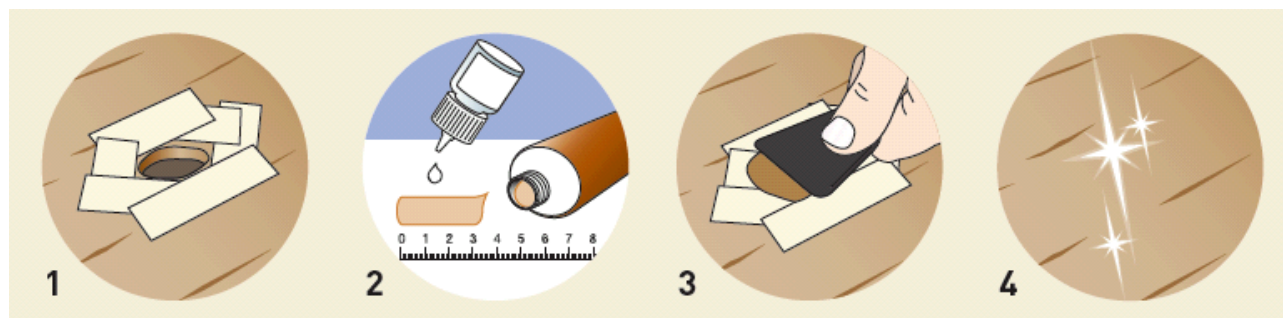

### Information

All above mentioned values were determined under laboratory conditions and defined laboratory materials and structures and may with different system flooring components deviate from these test values. For all of the mentioned performance values inaccuracies are possible owing to the testing methods.

The information given above is based on our current state of knowledge and should be used for information of our product application. This should not be taken to as an assurance of certain quality of our products or their use for specific purposes. Subject to change, legal obligations cannot be derived from the information in this document. Existing commercial protective rights are to be observed.

### A note on validity

This technical data sheet has been carefully drawn up to the best of our knowledge. It is intended for information only and does not constitute a guarantee in terms of product properties or suitability for specific applications. We accept no liability for any mistakes, errors in standards, or printing errors. In addition, technical changes may result from the further development of EGGER accessories as well as changes to standards and public law documents. This technical data sheet is not an instruction for use and is not a legally binding document.